

RJSPS16B SERIES

LED INDICATOR



Features

Installation diameter: 16/22mm
 Degree of Protection: IP65
 Silver Plated of contact: 3 μ
 Compact design save space
 Momentary, Maintained, Selector and E-stops LED
 Super bright LED cold light source lamp display

Related certification

Standard	signal	Agency certification
UL 508 CSA C22.2 No. 14		UL Recognized File No.E307512
GB14048.5		Under certification
EN60947-5-1 EN60947-5-5		Self-declaration (According to the European Low Voltage Directive)

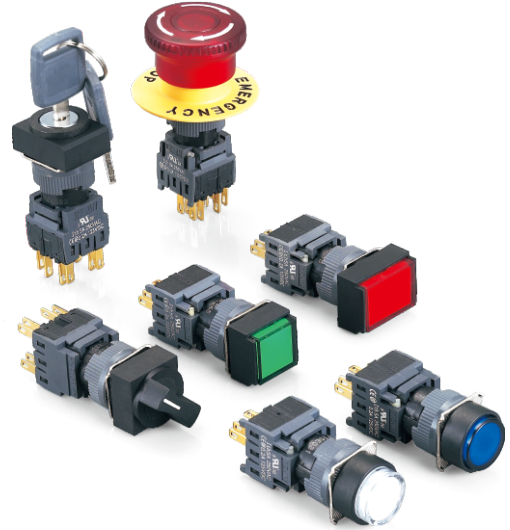

Specifications

Degree of Protection	IP40, Customizable IP65
Contact Configuration	SPDT, DPDT, TPDT
Maximum Voltage	250V AC/DC
Thermal Current	5A
Minimum Applicable Load	5V AC/DC, 1mA
Contact Material	Silver alloy (gold plated)
Terminal Style	110 terminal type tab
Operating Temperature	-25°C to +60°C
Operating Humidity	45 to 85% RH
Contact Resistance	50mΩ maximum

Electrical Life	100,000 Operations minimum
Mechanical Life	Maintained: 100,000 Momentary: 1,000,000 Selector /Keylock: 250, 000 (operations minimum)
Dielectric Strength	1500VAC 1min
Insulation Resistance	100MΩ minimum (500V DC megger)
Vibration Resistance	10 to 55Hz, amplitude 1.2mm p-p
Degree of Protection	>10G

LED Ratings

Bead Voltage	Current
3V DC	8mA
6-48V AC/DC	7-10mA
110-220V AC	2-3mA

Contact Ratings (AC-15 DC-13)

Working voltage		24V	110V	220V
AC (50/60Hz)	Resistive	—	1.0A	0.5A
	Inductive	—	0.7A	0.5A
DC	Resistive	1.0A	0.2A	—
	Inductive	0.7A	0.1A	—

RJSPS16B SERIES

LED INDICATOR



Installation size

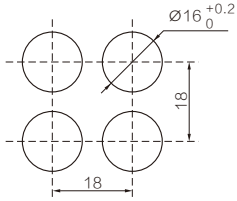

Round

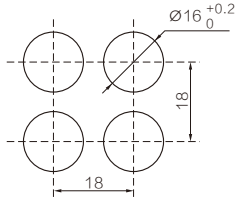

Square

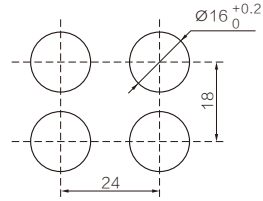

Rectangle

Contacts Circuit

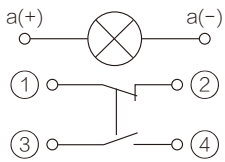

With LED circuit

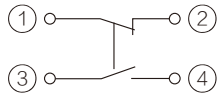

Without LED circuit

LED Circuit

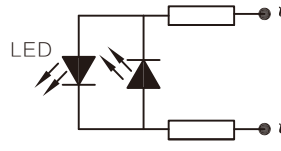

6.3VAC, 12VAC, 24VAC 48VAC, 110VAC, 220VAC
For 6VAC, 12VAC, 24VAC, 48VAC, 110VAC, 220VAC

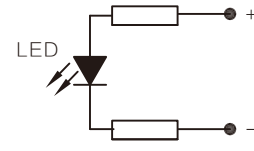

6.3VDC, 12VDC, 24VDC For 6.3VDC, 12VDC, 24VDC

Terminal style

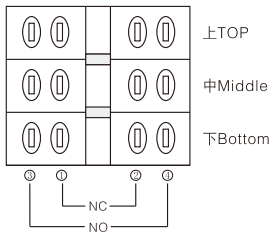

As shown at right, the base of product to be seen as front side, which show terminal disposition and inside coil drawing.

Product assemble contact 1C(1a+1b), if needed, Please appoint to add at least 3C(1a+1b)

RJSPS16B SERIES

LED INDICATOR



Product appearance			Top Color	Rated Voltage
Round RJSPS16B	Square RJSPS16B	Rectangle RJSPS16B	<ul style="list-style-type: none"> ■ Red ■ Green ■ Yellow ■ White ■ Blue 	D:24VDC E:12VDC F:6.3VDC A1:110VAC A2:220VAC

