

# RJSPS22E SERIES

EMERGENCY STOP SWITCH



Emergency Stop Switch

## Specifications

Operating Temperature	-20 ~ 55°C			
Operating Humidity	45-85%			
Store Temperature	-45 ~ 80°C			
Store Humidity	95%RH			
Degree of Protection	IP65		IP20	
Insulation Resistance	100MΩ			
Dielectric Strength	2500 VAC		2000VAC	
Vibration Resistance	10~500Hz - 0.35mm 50m/s <sup>2</sup>		5~55Hz 0.5mm	
	10~500Hz - 0.35mm 50m/s <sup>2</sup>		30Hz 1.5mm	
Shock Resistance	150m/s <sup>2</sup>		100m/s <sup>2</sup>	
	1000m/s <sup>2</sup>		100m/s <sup>2</sup>	
Mechanical Life	250,000	5,000,000	250,000	250,000
		1,000,000	100,000	100,000
Electrical Life	100,000		100,000	
			50,000	

## Installation Size

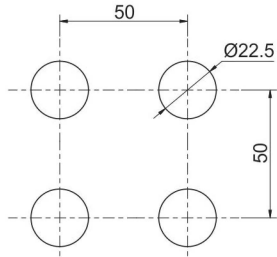

## Contact Ratings

Rated insulation voltage	600V				
Rated current	10A				
Rated voltage	24V	120V	240V	380V	
AC (50/60Hz)	(AC-12)	10A	10A	6A	2A
	(AC-15)	10A	6A	3A	1.9A
DC	(DC-12)	8A	2.2A	1.1A	-
	(DC-13)	4A	1.1A	0.55A	-

## How to Order:



Mounting Size	Operation Type	Operation Characteristic	Contact Structure	Selection Code
Ø22	Selector (2P) Selector (3P) Key Switch (2P) Key Switch (3P)	Round Round with LED	. NO NC 2NO NC NO+NC	2 position Maintained 3 position Maintained 2 position Momentary 3 position Left Momentary, Right Maintained 3 position Right Momentary, Left Maintained 3 position Momentary

# RJSPS22E SERIES

EMERGENCY STOP SWITCH



## Emergency Stop Switch

Product	Function	Contact	Model	Colour
Ø40mm RJSPS22E Emergency Stop 2 	Push-lock Turn Reset	1NC	<b>RJSPS22E -8101</b>	Rated Voltage  R Red
		2NC	<b>RJSPS22E -8102</b>	
Ø40mm RJSPS22E Emergency Stop 	Push-lock Turn Reset	1NC	<b>RJSPS22E -9101</b>	R' Red
		2NC	<b>RJSPS22E -9102</b>	
RJSPS22E Emergency Stop 3 	Push-lock Turn Reset	1NC	<b>RJSPS22E -B1101</b>	R Red
		2NC	<b>RJSPS22E -B1102</b>	

When pressed, the button is locked in the depressed position, and is reset when either pulled or turned clockwise.

