

SRS5 SERIES

ROTARY SWITCH



General Specifications

Switching Combination	: see over leaf
Current Rating	: 130mA (Max)
Voltage Rating	: 150V DC/AC (Max)
Switching power	: 5 VA (Max)
Contact Resistance	: 25m Ohm Max. (initial)
Insulation Resistance	: 100M Ohm Min.
Operating Force	: 1kgf-cm(Max)
Indexing Angle	: 30°
Operating Life non load	: 20,000 CYCLES Min.
Operating Life at full load	: 15,000 CYCLES Min.
Switching Mode	: Shorting and non shorting
Solder Specifications	: 260 °C for 3 seconds
Operating Temperature	: -10 °C ~ +60°C

Materials

Cap	: Polyamide (PA)
Movement	: Polyamide (PA)
Case	: Polyamide (PA)
Fixed Contact	: Brass with gold plating
Moving Contact	: Phosphor bronze (PBS) with gold plating
Spring	: Stainless steel
Cap style C1 Handle	: Aluminum
Cap style D/E Handle	: Polycarbonate(PC)
Cap style F	: Polycarbonate(PC)

Dimension

/ Cap style A

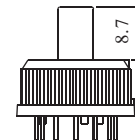
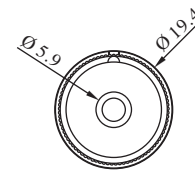

/ Cap style D

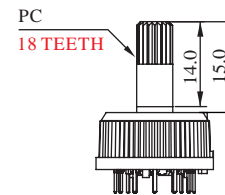
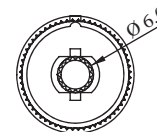

/ Cap style B

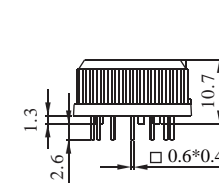
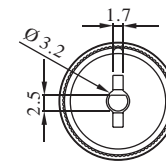

/ Cap style E

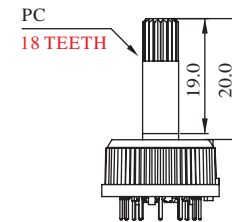
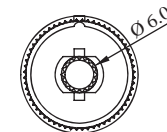

/ Cap style C1 (with E-ring)

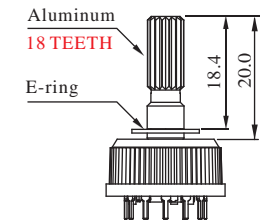
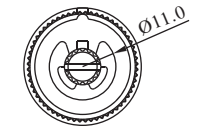

/ Cap style F

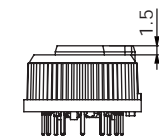

SRS5 SERIES

ROTARY SWITCH



P.C. Board layout & Contact configuration

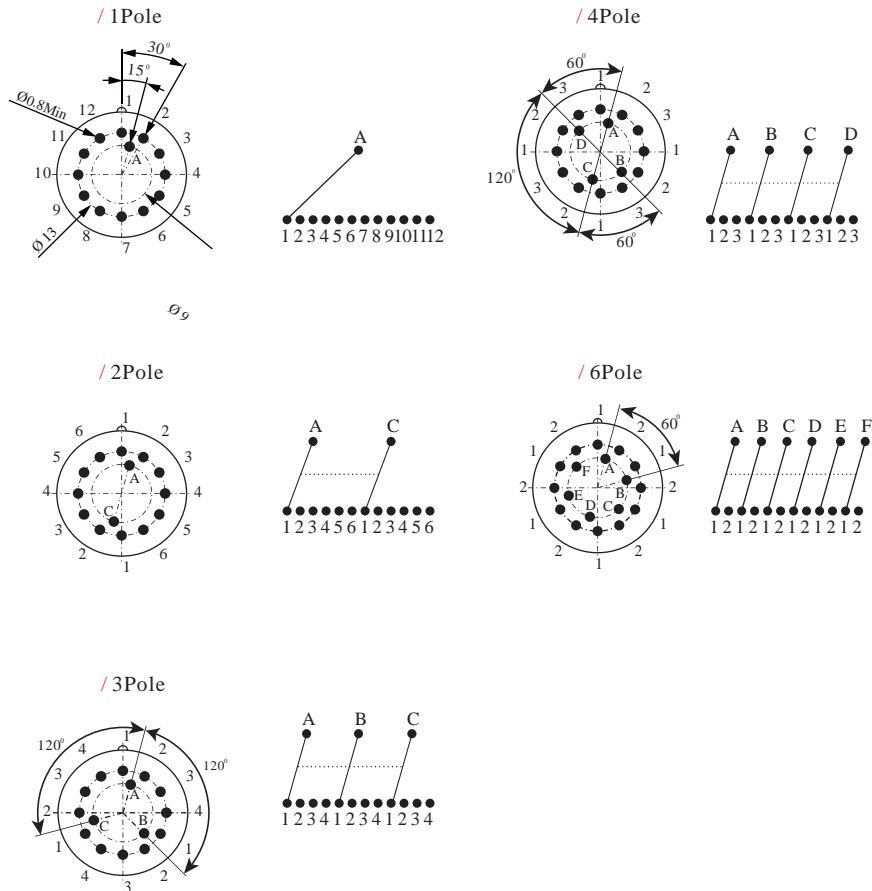

How to Order

S R S 5 — [] — [] — []

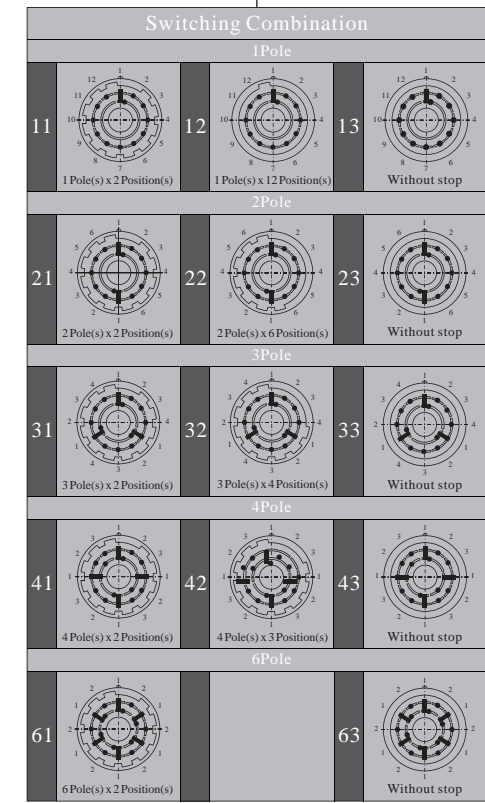
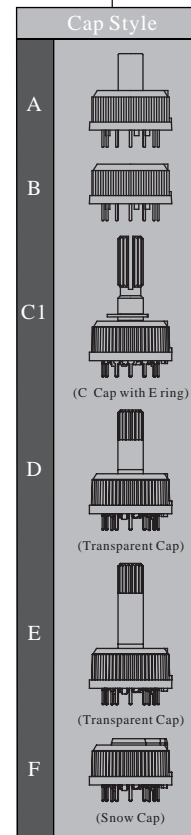

EXAMPLE : SRS5-A-33-NS

Operating Mode	
YS	Shorting (make-before-break)
NS	Non-Shorting (break-before-make)