

TC013 SERIES

LED TACT SWITCH



Feature :

- Small size
- Bi-color LED illuminated available
- Long electrical life cycles

Application :

- Consumer products
- Computer products
- Instrumentation
- Communication equipments

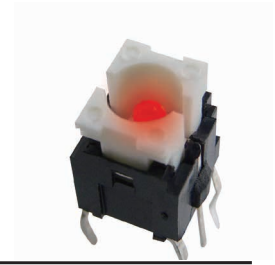

SWITCH SPECIFICATIONS	
POLE - POSITION	1P1T , with LED
CONTACT RATING	12 V DC , 50 mA
CONTACT RESISTANCE	100 mΩ MAX. 1.5 V DC ; 100 mA , by Method of Voltage DROP
INSULATION RESISTANCE	100 MΩ MIN. 500 V DC
DIELECTRIC STRENGTH	Breakdown is not Allowable ; 500 V AC for 1 Minute
OPERATING FORCE	180 ± 50 gf
OPERATING LIFE	500,000 cycles
OPERATING TEMPERATURE RANGE	-40°C ~ 85°C
TOTAL TRAVEL	0.2 ± 0.1 mm

LED SPECIFICATIONS								
ATTENTION LEDs are Electrostatic Sensitive devices 	Unit	Value / LED Color						
		Blue (5mA)	Pure Green	Red	Yellow	Orange	Green	White
LUMINOUS INTENSITY@20mA I _v	mcd	25	180	200	200	250	55	250
Dominant Wavelength λ _D	nm	470	525	630	590	601	567	/
FORWARD VOLTAGE@20mA V _f	V	2.8	3.2	1.95	2	2.1	2.1	4

■ A single bin cannot be ordered, please contact us in advance if you need a particular bin sorting before placing your order to clarify the lead time, MOQ and pricing

▶ HOW TO ORDER

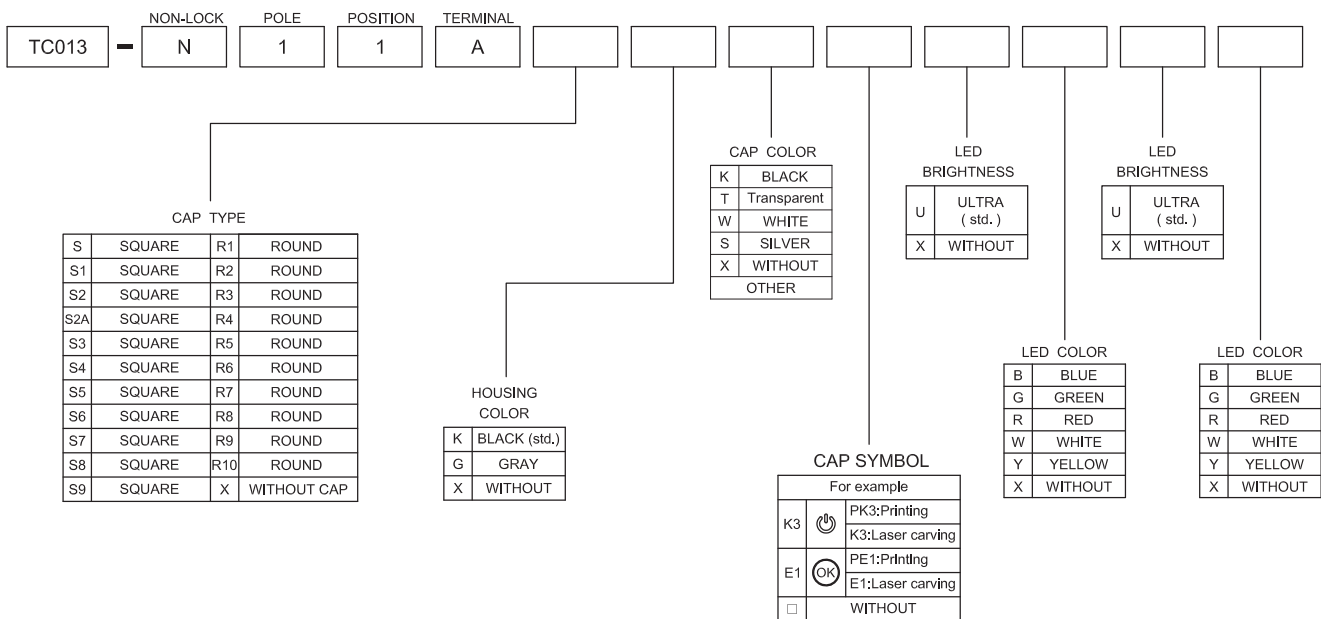

► **DIMENSION**

TC013-N11AXXX□□□□

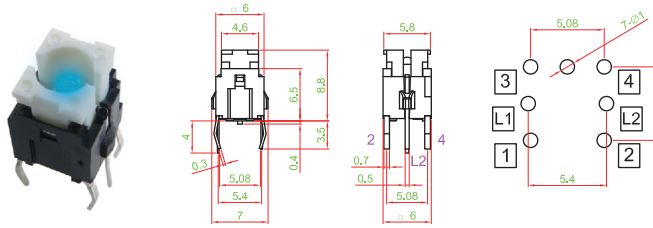

TC013-N11AS1XX□□□□

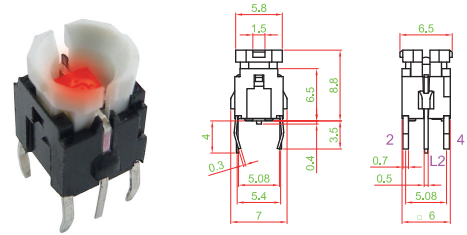

► **CAP TYPE (NO HOUSING/ CAP ONLY)**

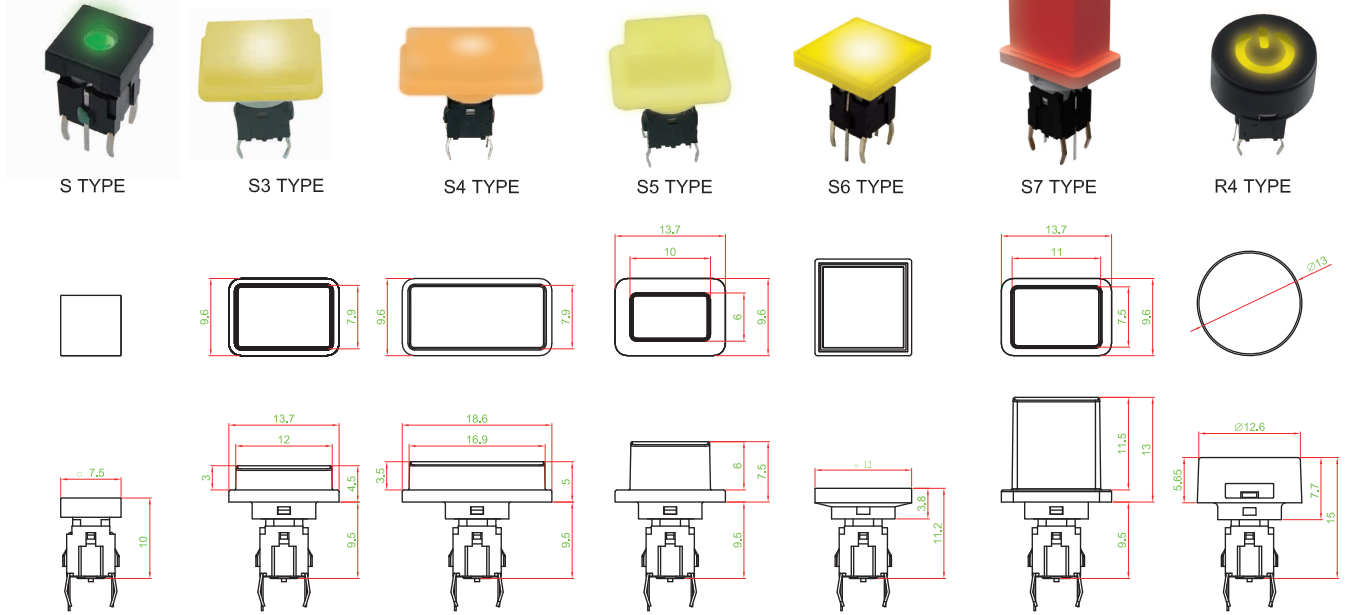

► **CAP WITH HOUSING**

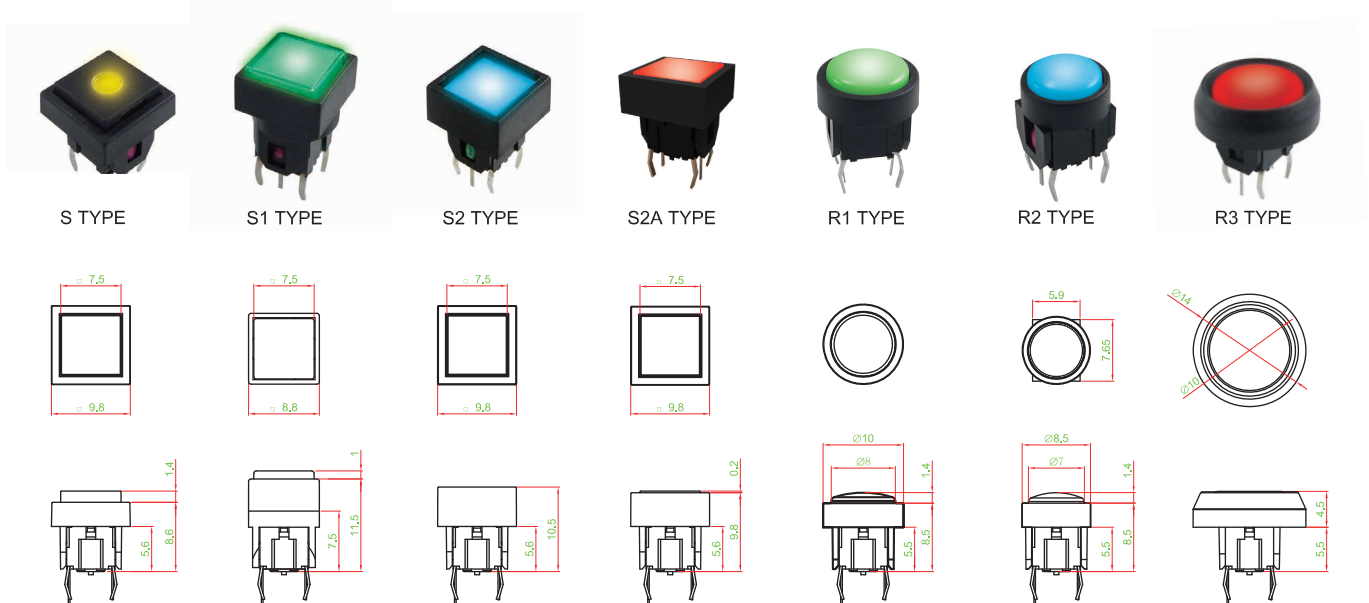

TC013 SERIES

LED TACT SWITCH



CAP WITH HOUSING



R5 TYPE

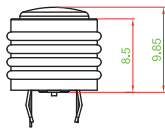
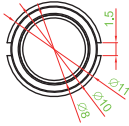

R6 TYPE

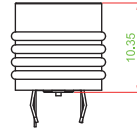
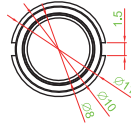

R7 TYPE (ODM)

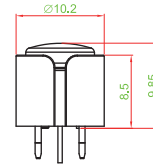
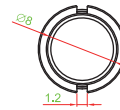

R8 TYPE (ODM)

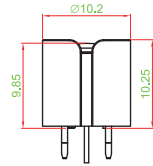
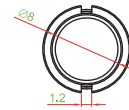

CAP WITH HOUSING (PANEL MOUNT)



S8 TYPE

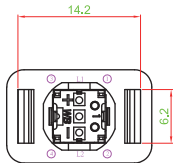
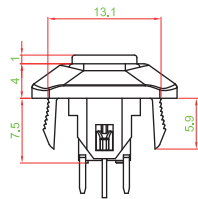
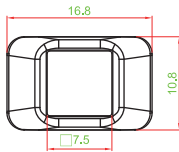

S9 TYPE

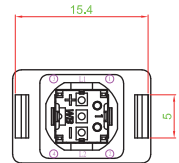
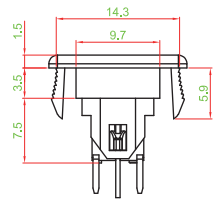
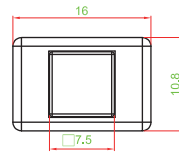

R9 TYPE

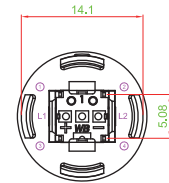
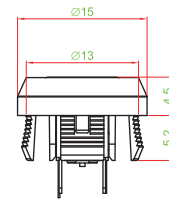
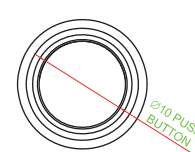

R10 TYPE

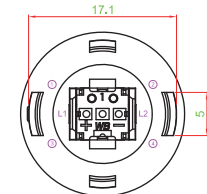
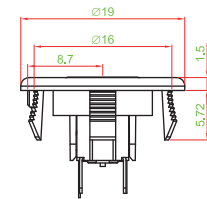
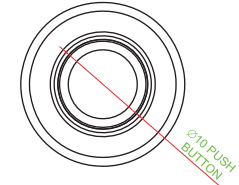

▶ PANEL CUT OUT	
PANEL THICK	W
0.75 ~ 1.25	13.2 ~ 13.3
1.25 ~ 2.0	13.3 ~ 13.4
2.0 ~ 3.0	13.4 ~ 13.5

▶ PANEL CUT OUT	
PANEL THICK	W
0.75 ~ 1.25	14.4 ~ 14.5
1.25 ~ 2.0	14.5 ~ 14.6
2.0 ~ 3.0	14.6 ~ 14.7

▶ PANEL CUT OUT	
Z	D
0 ~ 0.5	13.0 ~ 13.1
0.5 ~ 2.0	13.1 ~ 13.2
2.0 ~ 2.5	13.2 ~ 13.4
2.5 ~ 3.0	13.4 ~ 13.6
3.0 ~ 3.5	13.6 ~ 13.8

▶ PANEL CUT OUT	
Z	D
0 ~ 0.5	16.0 ~ 16.1
0.5 ~ 2.0	16.1 ~ 16.2
2.0 ~ 2.5	16.2 ~ 16.4
2.5 ~ 3.0	16.4 ~ 16.6
3.0 ~ 3.5	16.6 ~ 16.8

CIRCUIT

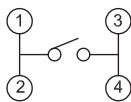

SINGLE COLOR

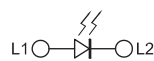

TWO COLOR

